

BHT-7000 Smart Knob Thermostat

WIFI Type



For Water Heating/Boiler/Electric Heating

New heating thermostat with knob BHT-7000
Six characteristics on the design

- *1.32 inch circular and 240*240 TFT shows your artistic taste.
- *Superfine aluminum side knob lets your fingers feel delicate.
- *Above 6H tempered glass keeps your screen away from scratches.
- *Agile push button gives you an excellent experience.
- *Seven colors ambient light increase color to your life.
- *Variety brushed back panel options are suitable for different home styles.

ABOUT YOUR THERMOSTATS

The BHT-7000 range has been developed to control electric underfloor, water heating or water/ gas boiler systems. These units are designed for use in commercial, industrial, civil and domestic properties

MODEL DEFINITION

GA: Water heating, 5A
GB: Electric floor Heating, 16A
GC: Water/Gas Boiler, 5A
L: Backlight
N: Modbus Communication
W: Wifi
S2: Both internal sensor and floor external sensor
For example: BHT-7000GA

In the box you will find

Thermostat	1pc	Screws	2pc
User Guide	1pc	Wall plate	1pc
QC Passed	1pc	(Floor sensor is Optional)	

TECHNICAL DATA

Power Supply:95 ~240 VAC, 50~60Hz or 24V DC/AC, 50~60Hz
Please check the information laser printed on the back of the thermostat for the actual voltage.
Current Load: 5A (water heating, gas boiler), 16A (electric heating)
Sensor: NTC3950, 10K
Accuracy: ±1°C
Set Temp. Range: 5-35°C
Room Temp. Range: 5-99°C
Display Temp. Range: 5 ~ 99°C
Ambient Temp.: 0~ 45°C
Ambient Humidity: 5 ~ 95 % RH (Non Condensing)
Storage Temp.: -10~ 45°C
Power Consumption: <1.5W
Timing Error: < 1%
Shell Material: PC +ABS (Fireproof)
Installation Box: 86 * 86mm Square or European 60mm Round Box
Wire Terminals: Wire 2 x 1.5 mm2 or 1 x 2.5 mm2
Protection Class: IP20
Buttons: Capacitive Touch Buttons

DIMENSION: (mm)

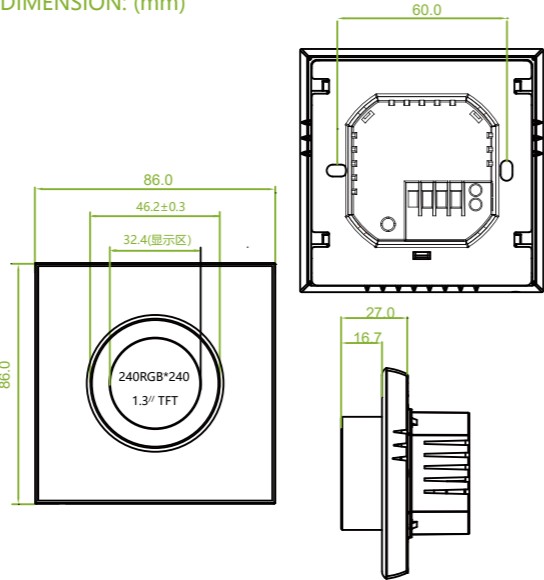

BEFORE WIRING AND INSTALLING

1. Read these instructions carefully. Failure to follow them could damage the product or cause a hazardous condition.
2. Check the ratings given in the instructions and on the product to make sure the product is suitable for your application.
3. Installer must be a trained, experienced service technician.
4. After installation is complete, check out product operation as provided in these instructions.

WIRING

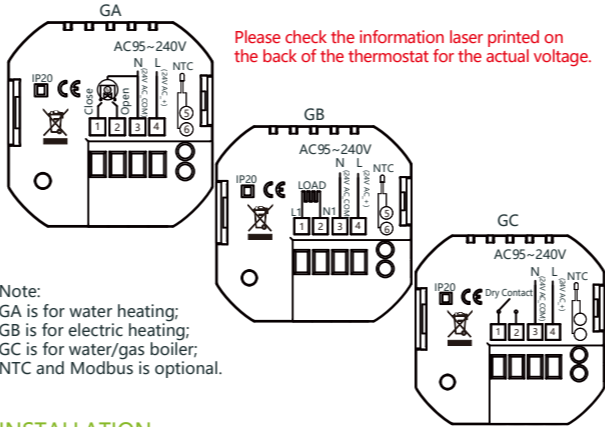

INSTALLATION

Your thermostat is suitable for installation within a standard 86mm pattrass box or European 60mm pattrass box.
Step 1. Keep power off. See Fig 1.
Step 2. Remove the mounting plate by pushing the display assembly. See Fig 2.

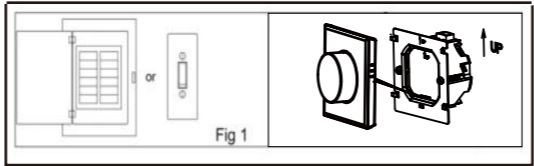

Step 3. Connect power supply, load into the appropriate terminals. (see "Wiring your thermostat" for details).
Step 4. Fix the mounting plate into the wall with screws in the box(Fig 4).

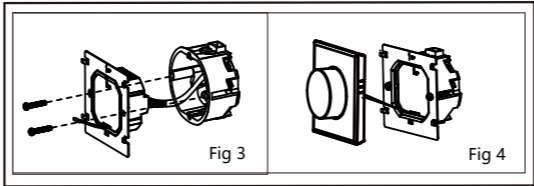

Step 5. Fix the thermostat body and the mounting plate by the lower button(Fig 5).
Step 6. Installation complete(Fig 6).

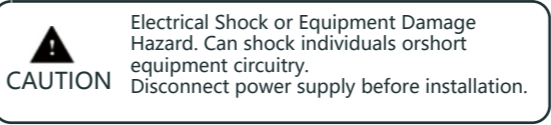
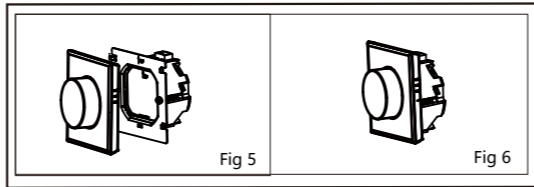

HOME SCREEN QUICK REFERENCE

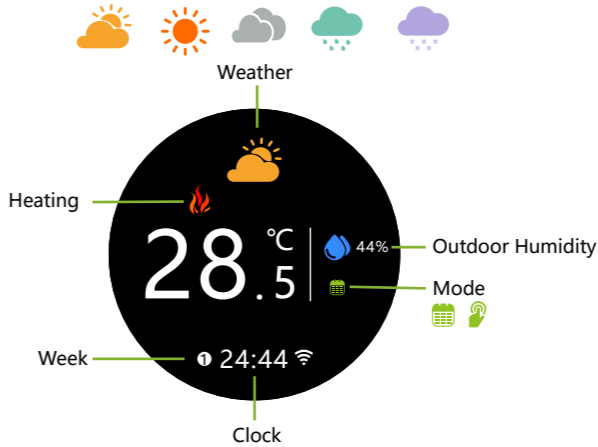

Note: The weather and humidity will be synchronized within 1 hour after the device is connected to the Internet for the first time, and the weather will be synchronized every hour thereafter.

Main control interface

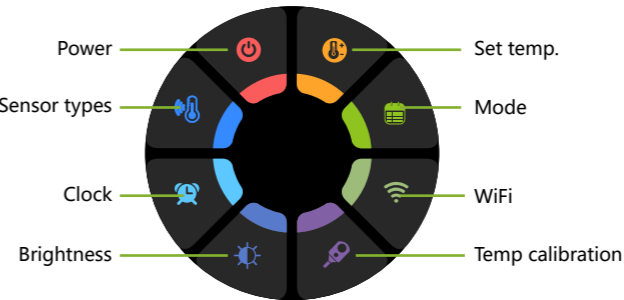

Tip: Press the screen to enter the Main control interface.

OPERATION

During Power On

1. Press the home screen to enter the control interface.
2. Rotate the control interface to select
3. Press the control interface to confirm
4. Long press the control interface to return the home screen

1. Power
ON: The thermostat is controlling the heating device.
OFF: The thermostat stops controlling the heating device.
2. Sensor types
In: Internal Sensor(to control the temp.)
Ou: External Sensor(to control the temp.)
AL: Internal/External Sensor (Internal sensor to control the temp., external sensor to limit the temp.)
3. Clock
Clock setting, the wifi version will automatically synchronize the local time after networking.
4. Brightness
Standby screen brightness setting. When set to 0, the screen will turn off the display.
5. Mode
Manual Mode Programming mode (Schedule mode.)
6. WiFi
ON: The thermostat is in the wifi distribution network state.
OFF: The thermostat is not in the wifi distribution network state.
7. Temp calibration
Please perform temperature correction after the thermostat has been working for 30 minutes.
8. Set temp.
Set temperature range 5~45°C

Set week program on your App

Default settings for program schedule

Time display	WEEKDAY (MONDAY—FRIDAY) (1 2 3 4 5 shows on screen)		WEEKEND (SATURDAY) (6 shows on screen)		WEEKEND (SUNDAY) (7 shows on screen)	
	TIME	TEMPERATURE	TIME	TEMPERATURE	TIME	TEMPERATURE
Period 1	06:00	20 °C	06:00	20 °C	06:00	20 °C
Period 2	08:00	15 °C	08:00	20 °C	08:00	20 °C
Period 3	11:30	15 °C	11:30	20 °C	11:30	20 °C
Period 4	13:30	15 °C	13:30	20 °C	13:30	20 °C
Period 5(1+2)	17:00	22 °C	17:00	20 °C	17:00	20 °C
Period 6(3+4)	22:00	15 °C	22:00	15 °C	22:00	15 °C

A separate schedule may be set for weekdays (Mon – Fri) and for weekends (Sat or Sun).

ABOUT WIFI

WI-FI CONNECTION

Before using your Wi-Fi thermostat for the first time,you must configure the Wi-Fi signal and settings through your smartphone or tablet ,This will allow communication between your connected devices

Step 1 Downlod your APP (Fig1-1)



Fig 1-1 Fig 1-2 IOS Fig 1-3 Android

Search for "Smartlife" in Apple Store or Google Play or use a browser to scan the QR code above (Figure 1-2), and complete account registration and installation according to the guidance of the APP.

Step 2. Connect the thermostat

Method 1: Bluetooth network distribution (Fig 2.1-Fig 2.4), turn on the Bluetooth switch of the mobile phone and set the thermostat to the WiFi enabled state, see the following tutorial to complete the connection and settings.



Setting wifi to ON means the thermostat is in wifi pairing state.



The wifi icon blinks quickly

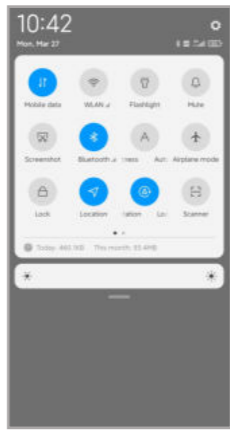

Fig2.1

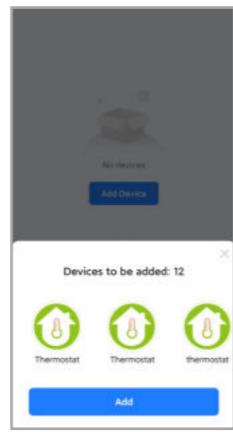

Fig2.2

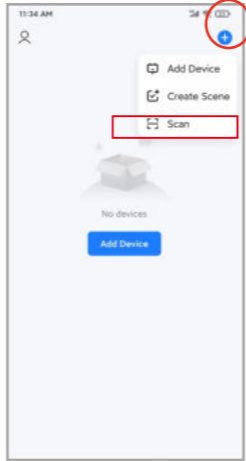

Fig2.5

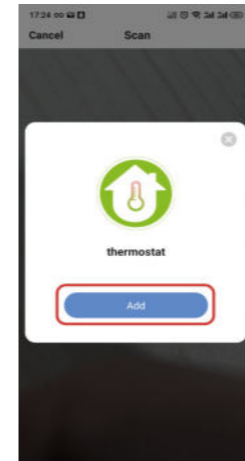

Fig2.6

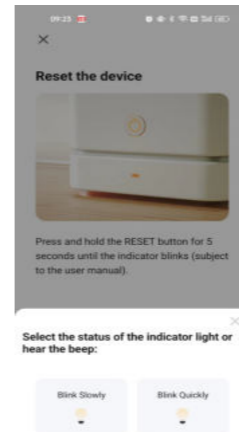

Fig2.7

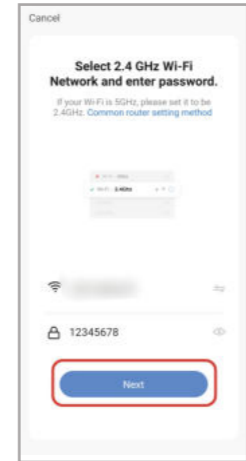

Fig2.8

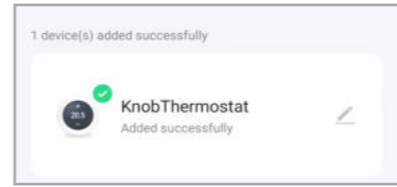

Fig2.9

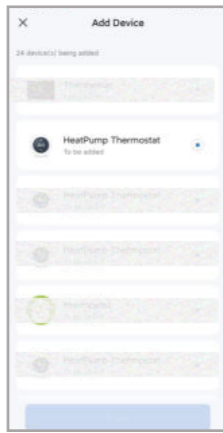

Fig2.3

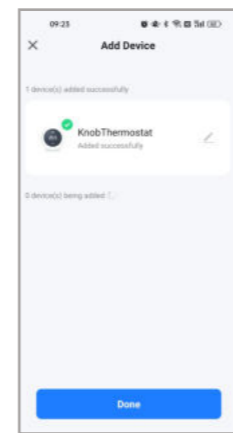

Fig2.4

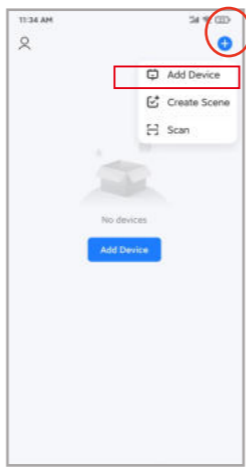

Fig2.5.1

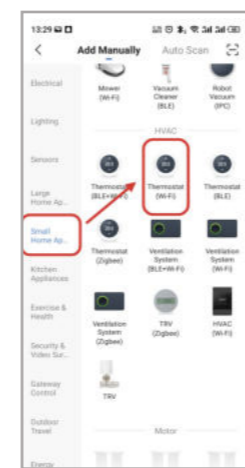
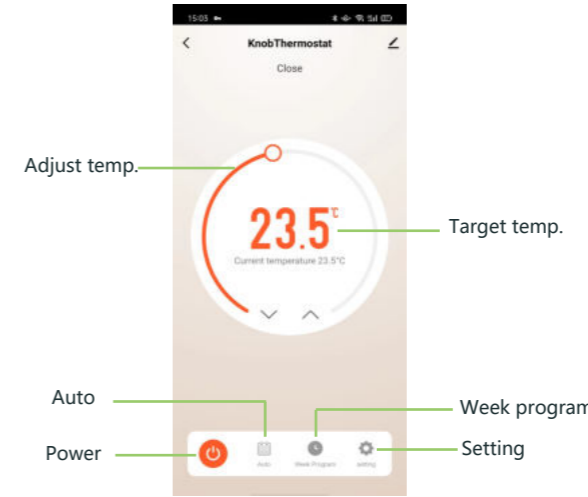

Fig2.6.1

Method 3: Ordinary distribution network guidance (Fig. 2. 5.1-Fig. 2.9)

APP operation interface description (heating thermostat))



More settings

setting		
Temperature correction	-5°C	>
State of the valve	Close	
Backlight brightness	20%	>
floor_temp	0.0°C	
sensorchoose	AL	>
deadzonetemp	1°C	>
hight_protect_temp	45.0°C	>
low_protect_temp	0.0°C	>

SIMPLE EXCEPTION HANDLING

No.	Phenomenons	Handling
1	Power is on but without display.	*Check if the terminals between LCD panel and Power Unit Box is loosen.
2	Without output but display works.	* Usea new LC panel or new Power Unit Box toreplace the old one.
3	Room Temp. Is a lttle different from the actual.	* Do temperature calibration in item 1 of high senior options

SERVICE

Your thermostat carries an 24 months warranty from date of purchase. Service outwith the warranty period mayincur a charge. More detail please contact with us directly.